

.76mm X 45° CHAMFER

M5X0.8 - 6H ∇ 10.00
PRESSURE PORT

\varnothing 25.00 TOOLING BALL
NOT INCLUDED

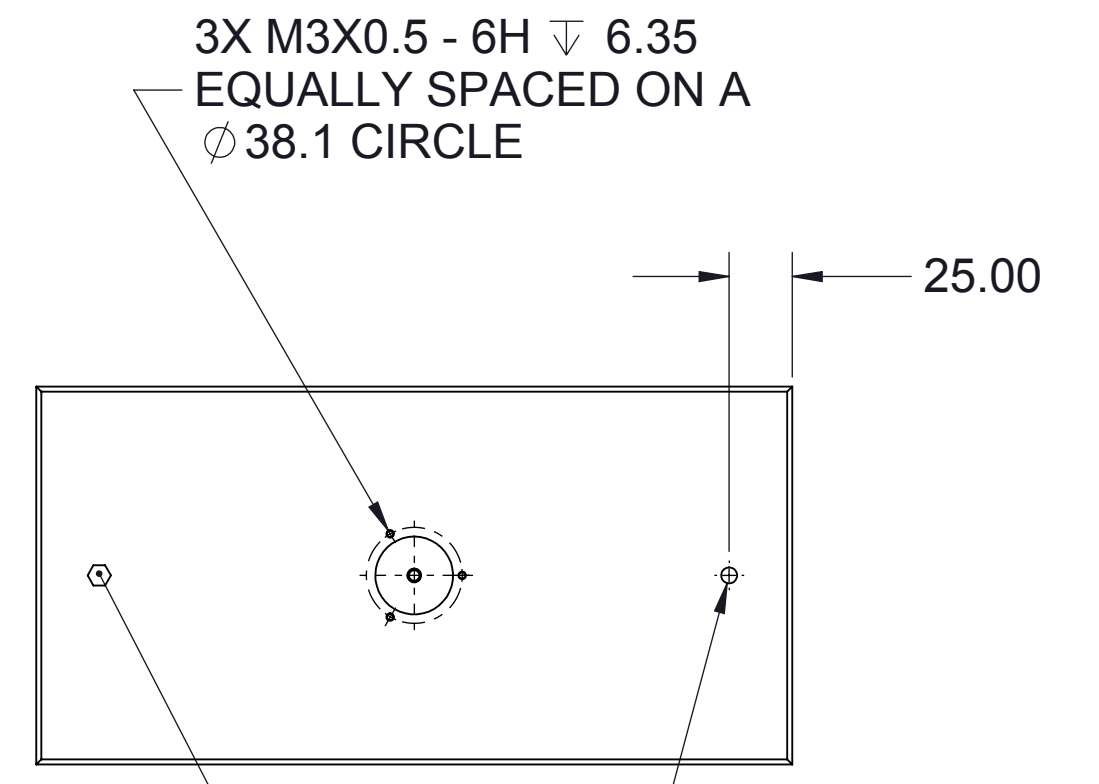

3X M3X0.5 - 6H ∇ 6.35
EQUALLY SPACED ON A
 \varnothing 38.1 CIRCLE

M5 AIR PORT PLUG
INCLUDED

PROPRIETARY ITEM:
This drawing contains information proprietary to New Way Air Bearings. Any reproduction, disclosure or use of this drawing or the information contained herein is expressly prohibited except as New Way may otherwise agree to in writing. © Copyright 2006, New Way Air Bearings. All rights reserved.

www.newwayairbearings.com

- NOTES:**
- ALL DIMENSIONS ARE REFERENCE UNLESS OTHERWISE SPECIFIED.
 - ALL DIMENSIONS ARE IN MILLIMETERS (mm).

TITLE: FLAT BEARING ASSEMBLY, 150mm X 300mm			NEWWAY air bearings	
DRAWN: MC	DATE: 7/29/2011	MATERIAL: ALUMINUM/CARBON		
CHECKED:	DATE:	MASS: 11.85 kg	EWO. NO.	
USED ON:	SHT. 1 OF 1	FINISH: BLUE ANODIZE	DWG. NO. S1215001-C	REV.