

8X ϕ .276[7.0] THRU ALL
 \square ϕ .433[11.0] ∇ .25[6.4]
 EQ. SP.

11°

8X ϕ .268[6.8] THRU ALL
 M8X1.25 - 6H ∇ .63[16.0]

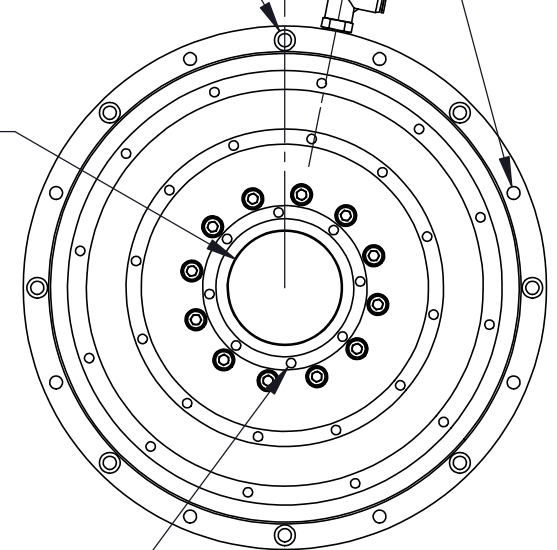

8X ϕ .197[5.0] ∇ .59[15.0]
 M6X1.0 - 6H ∇ .59[15.0]
 BOTH SIDES

∇ .001 [.025]
 WHEN SPINDLE IS
 ROTATING SUPPLIED
 WITH 60PSI[4.1 BAR]
 SUPPLY PRESSURE
 (MOUNTING SURFACE)
 (BOTH SIDES)

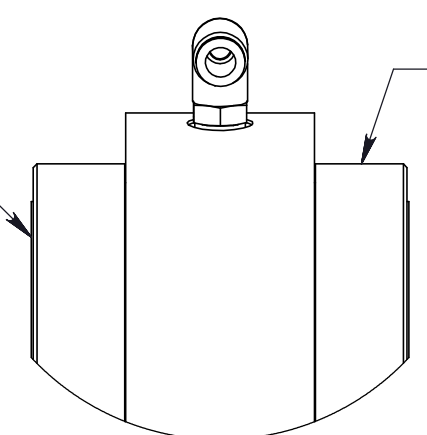

∇ .001 [.025]
 WHEN SPINDLE IS
 ROTATING SUPPLIED
 WITH 60PSI[4.1 BAR]
 SUPPLY PRESSURE
 (MOUNTING SURFACE)
 (BOTH SIDES)

DETAIL A
 SCALE 1 : 2

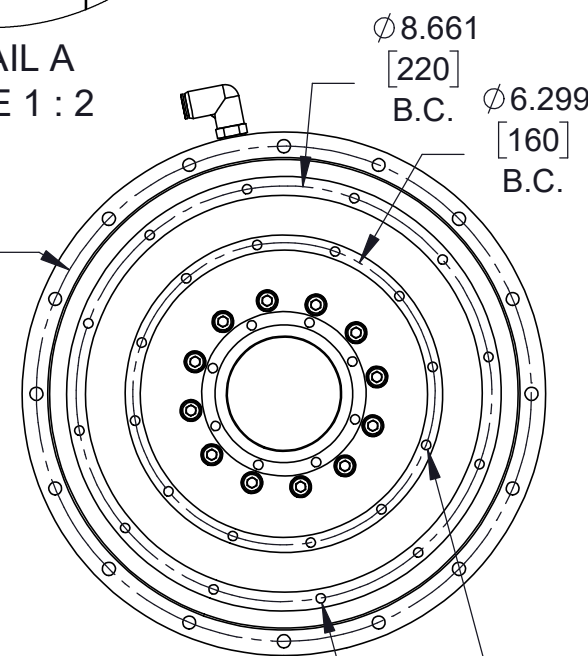

ϕ 8.661
 [220]
 B.C.
 ϕ 6.299
 [160]
 B.C.

G1/8 ∇ .75
 AIR SUPPLY PORT
 SHOWN WITH 8mm
 ONE TOUCH
 SWIVEL FITTING

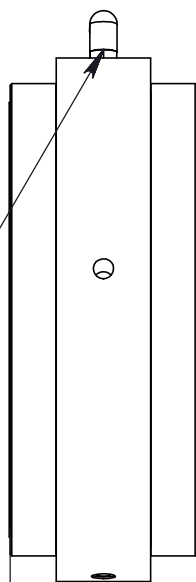

ϕ 2.362
 [60]

2X ϕ 9.843
 [250]

ϕ .05 TIR A

ϕ 10.905
 [277]

ϕ 10.315
 [262]
 B.C.

∇ .0005 [.013] B

∇ .0005 [.013] B

∇ .005 [.013]

∇ .005 [.013]

12X ϕ .197[5] ∇ .59[15]
 M6X1.0 - 6H ∇ .59[15]
 BOTH SIDES

12X ϕ .197[5] ∇ .59[15]
 M6X1.0 - 6H ∇ .59[15]
 BOTH SIDES

3.935
 [99.9]

1.977
 [50.2]

G1/16 ∇ .608[15.4]
 VENT PORT
 DO NOT OBSTRUCT

.983
 [25]

NOTES:
 1. ALL DIMENSIONS ARE REFERENCE
 UNLESS OTHERWISE SPECIFIED.

PROPRIETARY ITEM:
 THIS DRAWING CONTAINS
 INFORMATION PROPRIETARY TO NEW
 WAY MACHINE COMPONENTS, INC. ANY
 REPRODUCTION, DISCLOSURE, OR USE
 OF THIS DRAWING OR THE
 INFORMATION CONTAINED HEREIN
 IS EXPRESSLY PROHIBITED EXCEPT AS
 NEW WAY MAY OTHERWISE AGREE TO
 IN WRITING. ALL RIGHTS RESERVED BY
 NEW WAY MACHINE COMPONENTS, INC.

TOLERANCES UNLESS OTHERWISE SPECIFIED ANGLES: $\pm 1/2^\circ$ DECIMALS: XX \pm .01 XXX \pm .005 FRACTIONS: $\pm 1/64$ SURFACE ROUGHNESS: ∇ RMS MAX. BREAK ALL SHARP EDGES: .005-.020	TITLE: SS-250 SPINDLE			
	DRAWN: JHA	DATE: 6/26/19		
	CHECKED:	DATE:	HEAT TREAT: N/A	DWG. TYPE:
	SCALE: 1:4	SHT. 1 OF 1	FINISH: N/A	DWG. #:
USED ON (NW #):	N/A		REV.:	- .02
				SS-250

4

3

2

1

B

B

A

A