

B

B

8X ϕ .260 [6.6] THRU ALL

\square ϕ .433 [11.0] ∇ .24^{+.01}_{-.00} [6.0^{+.3}_{.0}]
EQ. SP.

ϕ 1.417 [36]

8X 45°

30°

8X 90°

M5 TO 5/32" O.D.
TUBE ONE TOUCH
FITTING

M5X0.8-6H
 ∇ .39
AIR PRESSURE
SUPPLY PORT

\parallel .0004 [.0102] B

\parallel .0004 [.0102] B

2.363 [60]

1.181 [30]

2X .591 [15]

\parallel .0004 [.0102]

\parallel .0004 [.0102]

2X .591 [15]

2.363 [60]

M5X0.8-6H ϕ 0.5 ∇ .02
VENT PORT
DO NOT OBSTRUCT

NOTES:

1. ALL DIMENSIONS ARE REFERENCE UNLESS OTHERWISE SPECIFIED.

PROPRIETARY ITEM:
THIS DRAWING CONTAINS
INFORMATION PROPRIETARY TO NEW
WAY MACHINE COMPONENTS, INC. ANY
REPRODUCTION, DISCLOSURE, OR USE
OF THIS DRAWING OR THE
INFORMATION CONTAINED HEREIN
IS EXPRESSLY PROHIBITED EXCEPT AS
NEW WAY MAY OTHERWISE AGREE TO
IN WRITING. ALL RIGHTS RESERVED BY
NEW WAY MACHINE COMPONENTS, INC.

\parallel .001 [.025]
WHEN SPINDLE IS
ROTATING SUPPLIED
WITH 60PSI[4.1 BAR]
SUPPLY PRESSURE
(MOUNTING SURFACE)
(BOTH SIDES)

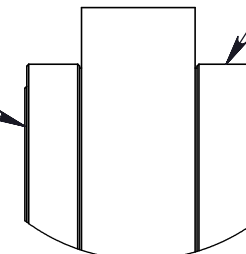

DETAIL A
SCALE 1 : 2

\parallel .001 [.025]
WHEN SPINDLE IS
ROTATING SUPPLIED
WITH 60PSI[4.1 BAR]
SUPPLY PRESSURE
(MOUNTING SURFACE)
(BOTH SIDES)

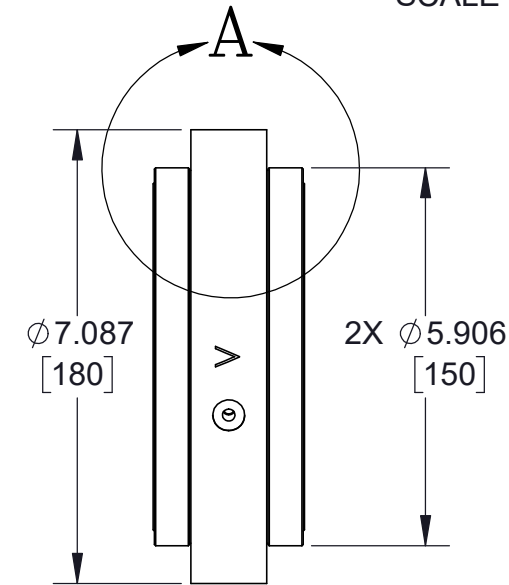

ϕ 6.496 [165]
B.C.

ϕ 4.906 [124.6]
B.C.

12X ϕ .165 [4.2] ∇ .49 [12.4]
M5X0.8 - 6H ∇ .39(\pm .01) [10.0(\pm .3)]
EQ. SP. ON BOTH SIDES

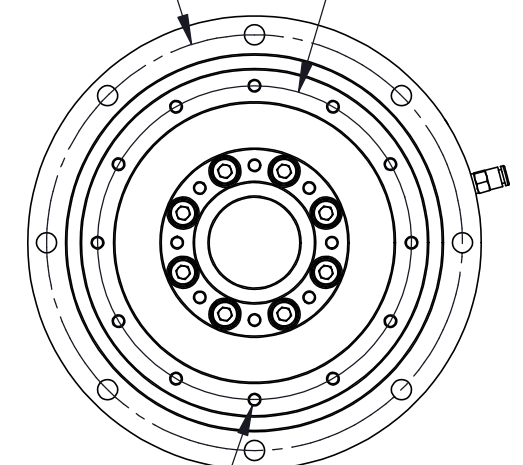

A

A

TOLERANCES UNLESS OTHERWISE SPECIFIED ANGLES: \pm 1/2° DECIMALS: XX \pm .01 XXX \pm .005 FRACTIONS: \pm 1/64 SURFACE ROUGHNESS: $\sqrt{\text{RMS MAX}}$ BREAK ALL SHARP EDGES: .005-.020	TITLE: SS-150 SPINDLE			
	DRAWN: RJP	DATE: 7/8/2019		
	CHECKED:	DATE:	HEAT TREAT: N/A	
	SCALE: 1:3	SHT. 1 OF 1	FINISH: N/A	
	USED ON (NW #): N/A			DWG. # SS-150

4

3

2

1