

4

3

2

1

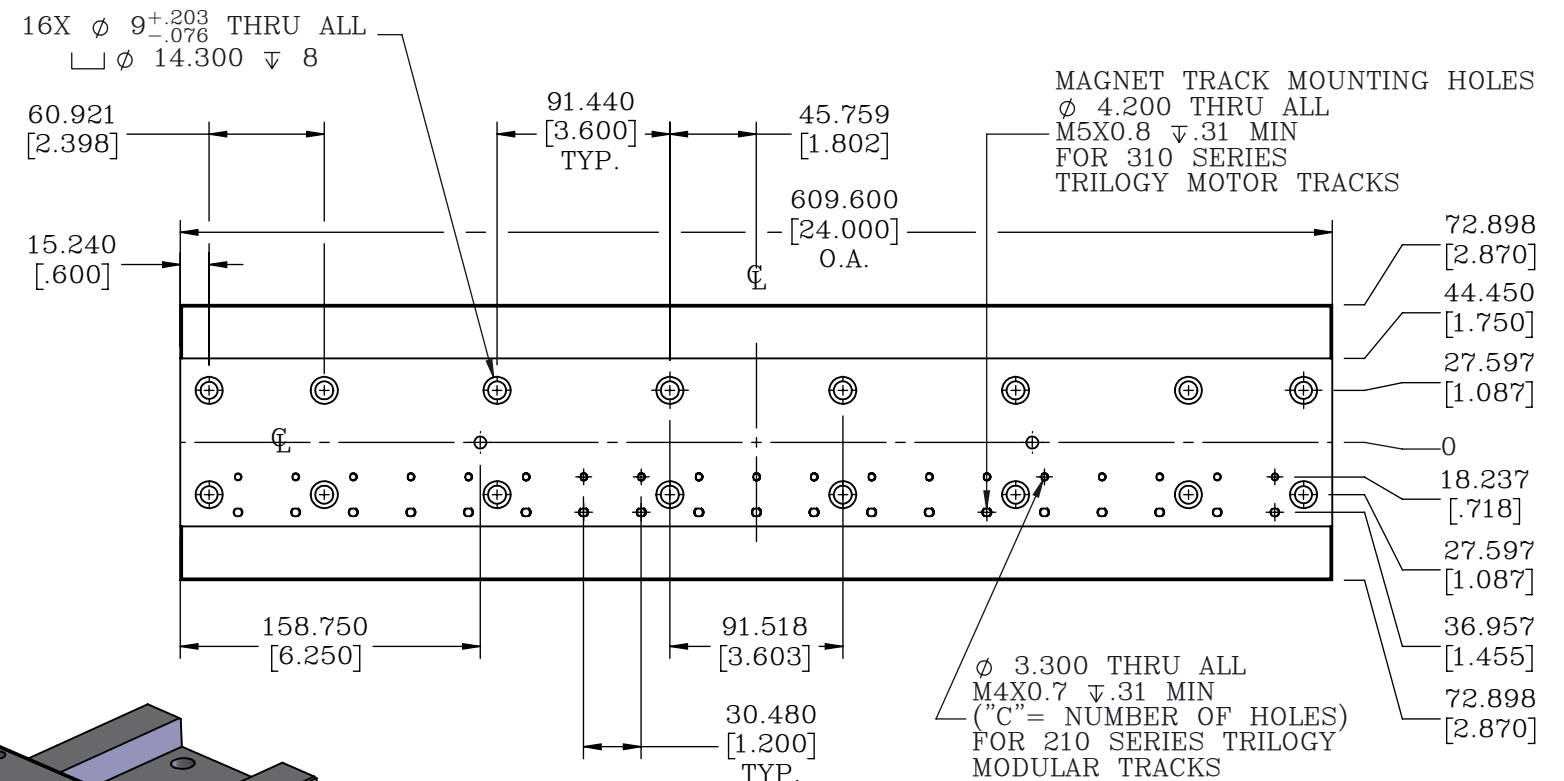
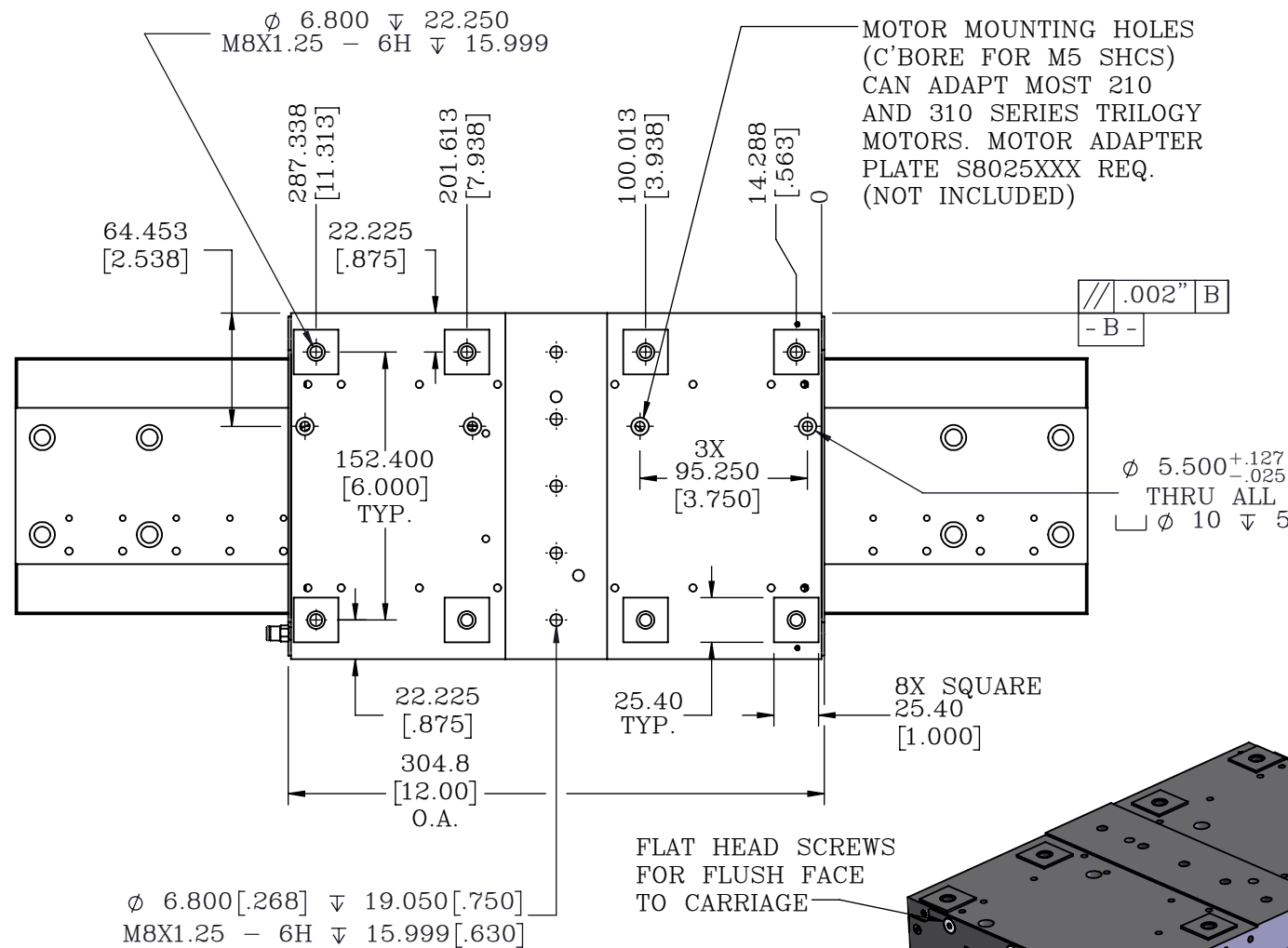
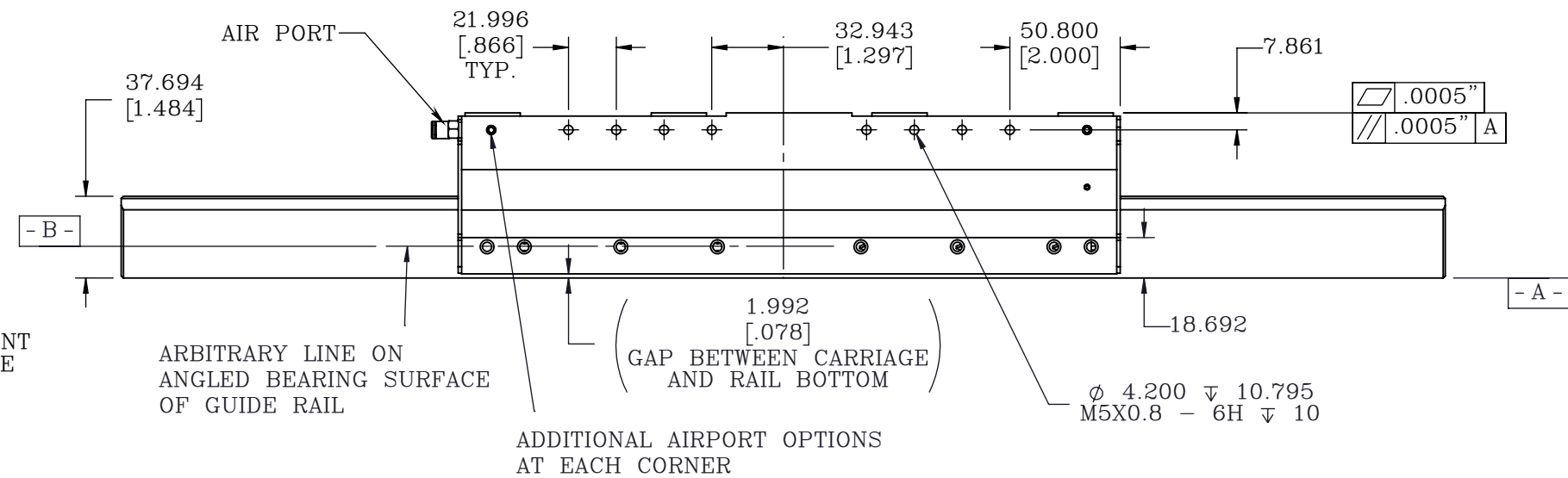
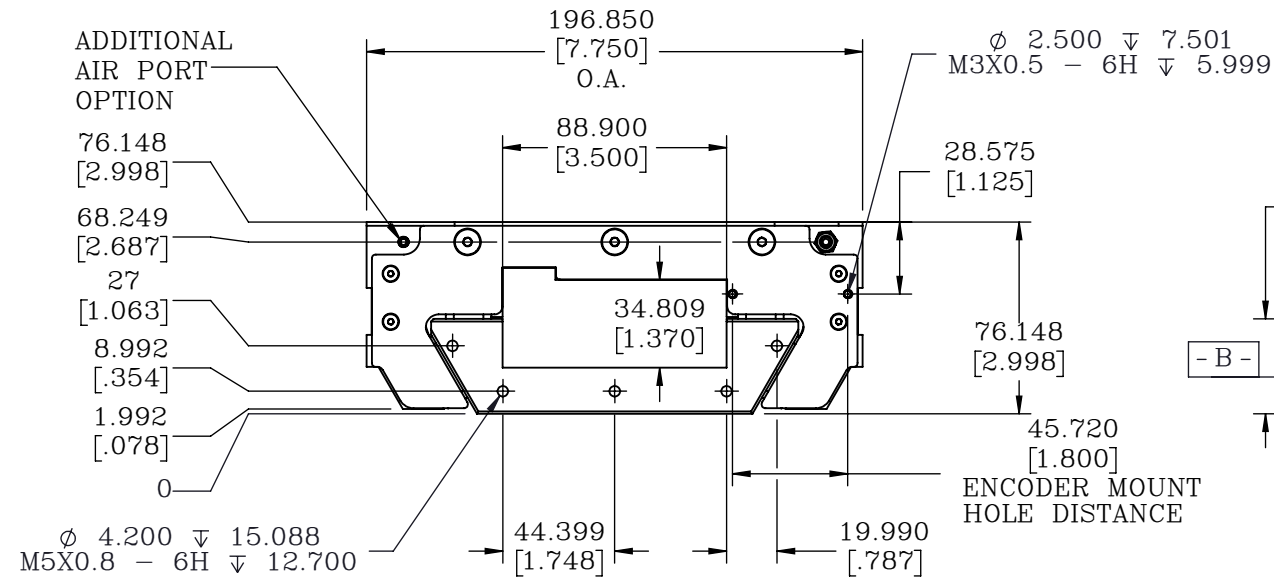

ALL DIMENSIONS IN MM, [INCHES]

PROPRIETARY ITEM:  
THIS DRAWING CONTAINS INFORMATION PROPRIETARY TO NEW WAY MACHINE COMPONENTS, INC. ANY REPRODUCTION, DISCLOSURE, OR USE OF THIS DRAWING OR THE INFORMATION CONTAINED HEREIN IS EXPRESSLY PROHIBITED EXCEPT AS NEW WAY MAY OTHERWISE AGREE TO IN WRITING. ALL RIGHTS RESERVED BY NEW WAY MACHINE COMPONENTS, INC.

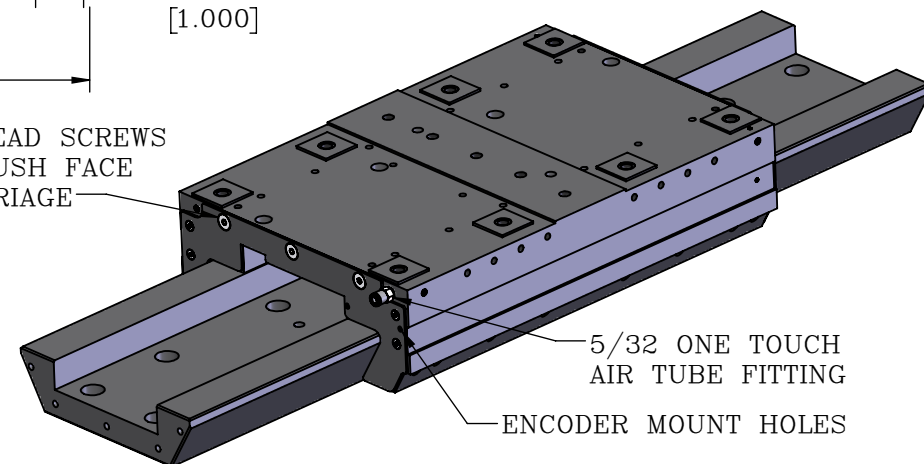

TOLERANCES UNLESS OTHERWISE SPECIFIED ANGLES: $\pm$ 1/2° DECIMALS: XX $\pm$ .01 XXX $\pm$ .005 FRACTIONS: $\pm$ 1/64 SURFACE ROUGHNESS: ✓ RMS MAX. BREAK ALL SHARP EDGES: .005-.020	TITLE: DOVETAIL W 610MM (24") RAIL AND 305MM (12") TRAVEL			
	DRAWN: ADK	DATE: 07/29/2021		
	CHECKED:	DATE:	HEAT TREAT:	
	SCALE: 1:2.5	SHT. 1 OF 1	FINISH: N/A	
USED ON (NW #): CUSTOMER DRAWING - REF ONLY	DWG. NO. S41-06300-145610		REV. -	

4

3

2

1