

"OAL" GUIDE BAR		STAGE TRAVEL	
inches	mm "XXX"	inches	mm
10	254	2	51
12	305	4	102
20	508	12	305

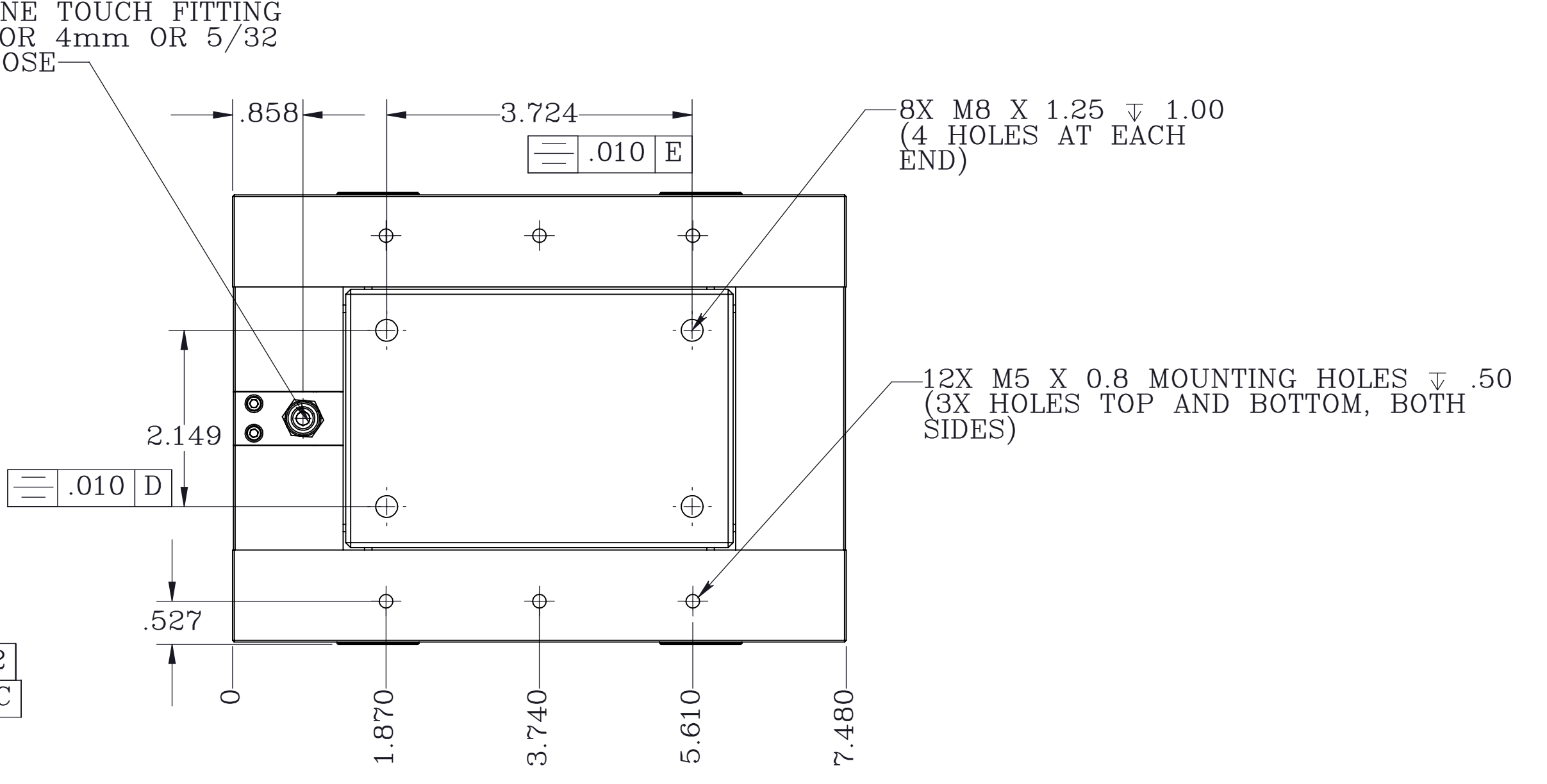
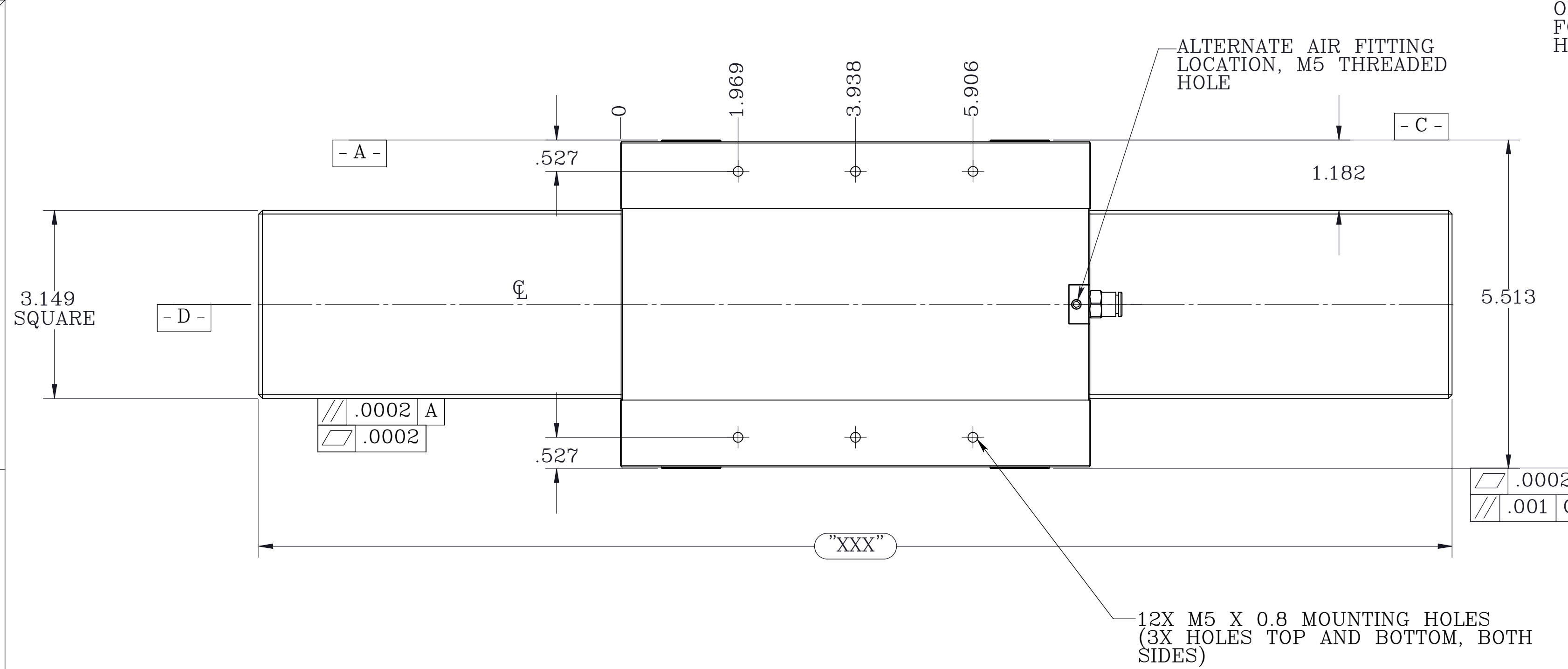
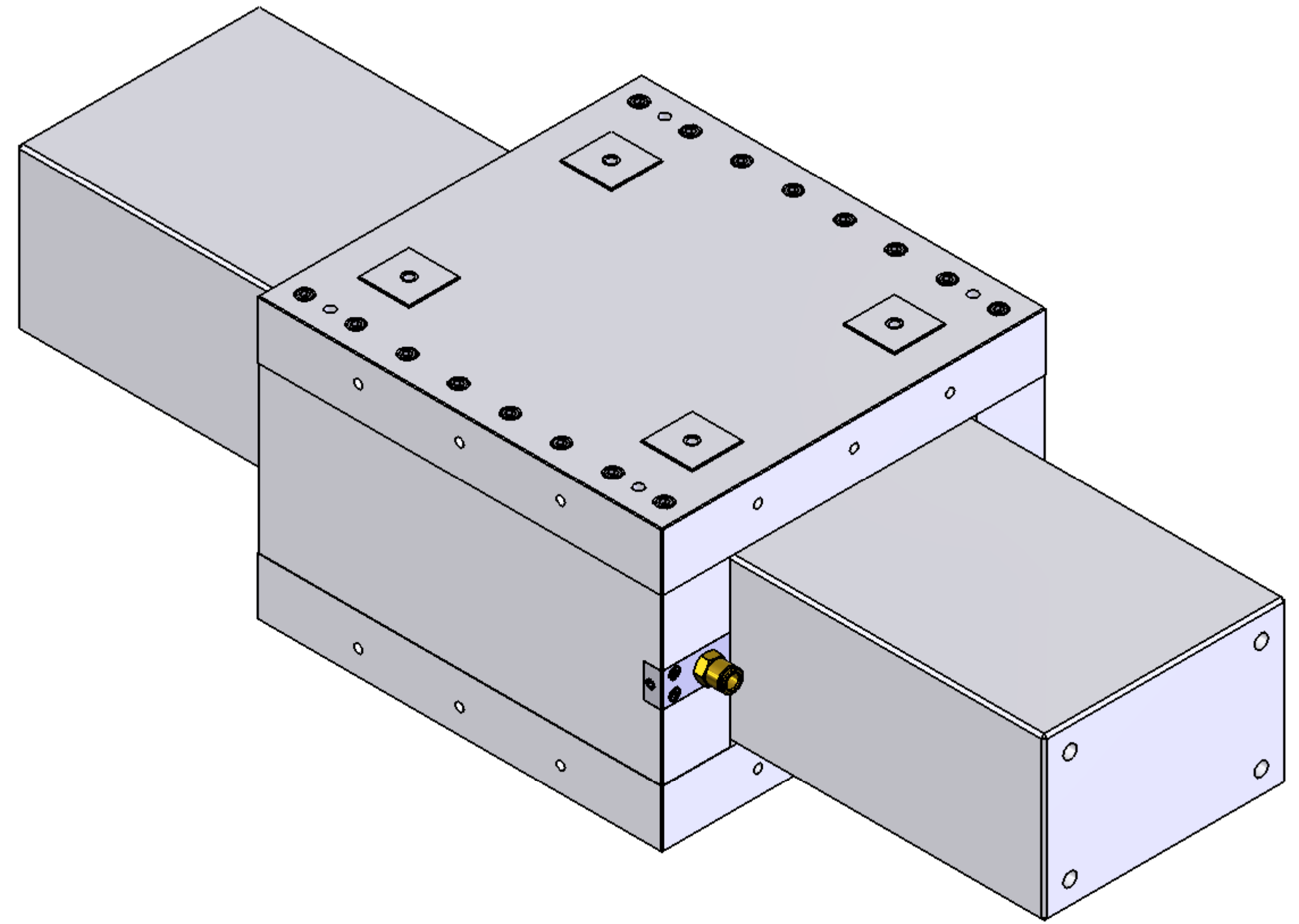
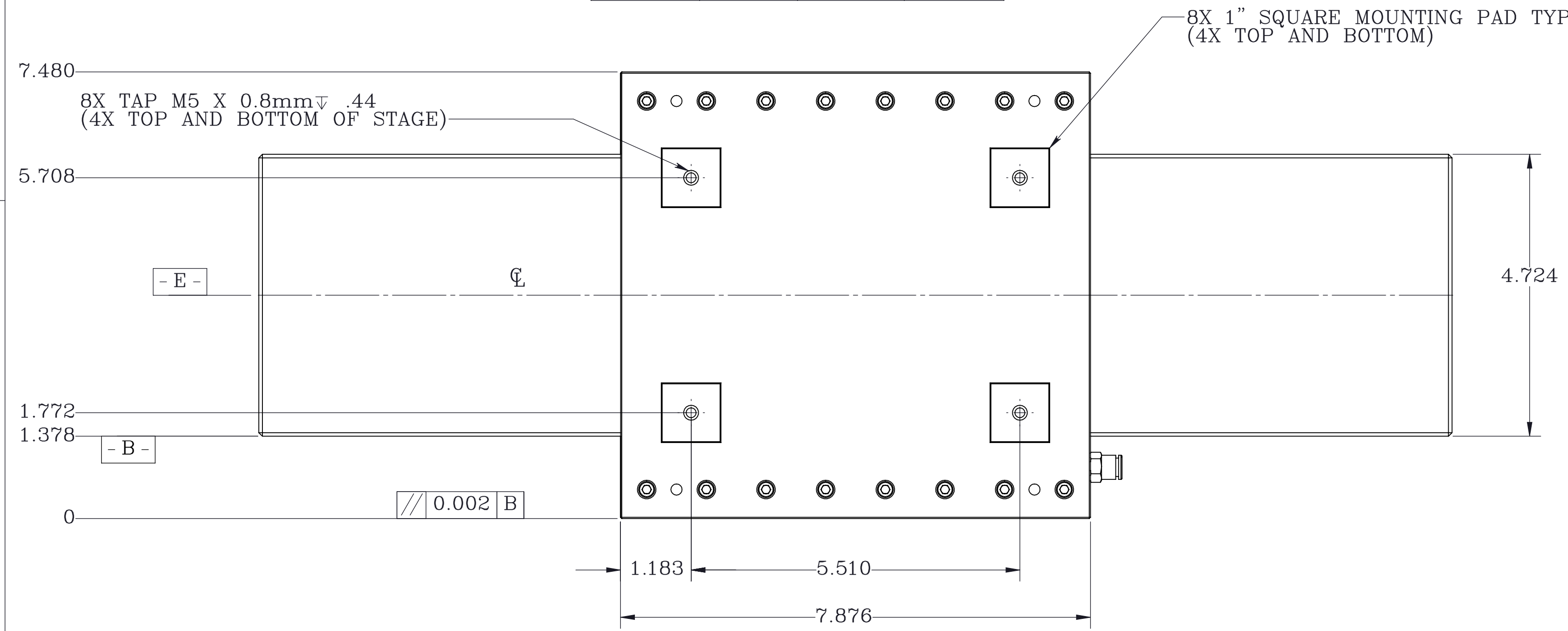

- NOTES:
- MATERIAL AND FINISH:
HOUSINGS AND GUIDE BAR: BLACK ANODIZED ALUMINUM
BEARINGS: POROUS CARBON
 - "XXX" IN mm DENOTES THE LAST 3 DIGITS OF THE ASSEMBLY PART NUMBER AS LISTED IN THE CHART ABOVE
 - CHAMFER OF .60 INCHES APPLIED TO ALL EDGES

PROPRIETARY ITEM:
THIS DRAWING CONTAINS INFORMATION PROPRIETARY TO NEW WAY MACHINE COMPONENTS, INC. ANY REPRODUCTION, DISCLOSURE OR USE OF THIS DRAWING OR THE INFORMATION CONTAINED HEREIN IS EXPRESSLY PROHIBITED EXCEPT AS NEW WAY MAY OTHERWISE AGREE TO IN WRITING. ALL RIGHTS RESERVED BY NEW WAY MACHINE COMPONENTS, INC.

TOLERANCES UNLESS OTHERWISE SPECIFIED		TITLE: 3 X 5 SLIDE ASSEMBLY		NEWWAY air bearings	
ANGLES: \pm 1/2°	DECIMALS: xx .010	DRAWN: CSS	DATE: 5/14/2014		
FRACTIONS: 1/64	SURFACE ROUGHNESS: 63 RMS MAX.	CHECKED:	DATE:	HEAT TREAT:	EW. NO.
BREAK ALL SHARP EDGES	.005-.020	SCALE: 2:3	SHT. 1 OF 1	FINISH:	DWG. NO. S40-01200-125XXX-C
		USED ON:			REV. B