

4

3

2

1

B

B

A

A

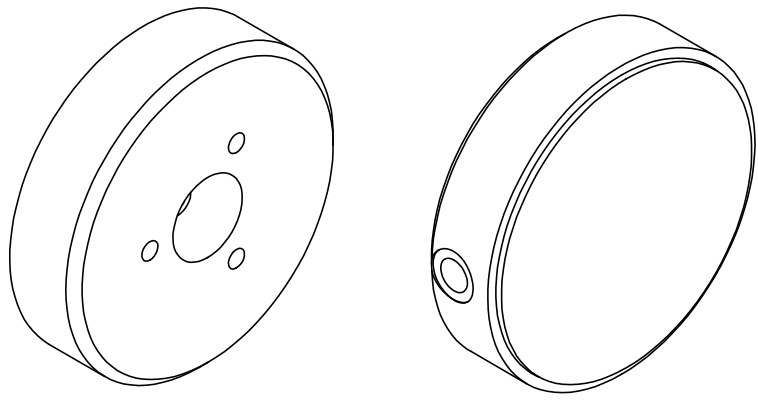

.00002 [.0005]

.51±.01  
[12.99±.38]

∅ 1.97  
[50]

∅ .51  
[13]  
TOOLING BALL  
NOT INCLUDED

.210  
[5.33]

∅ 1.84  
[46.84]

∅ .85  
[21.59]  
B.C.

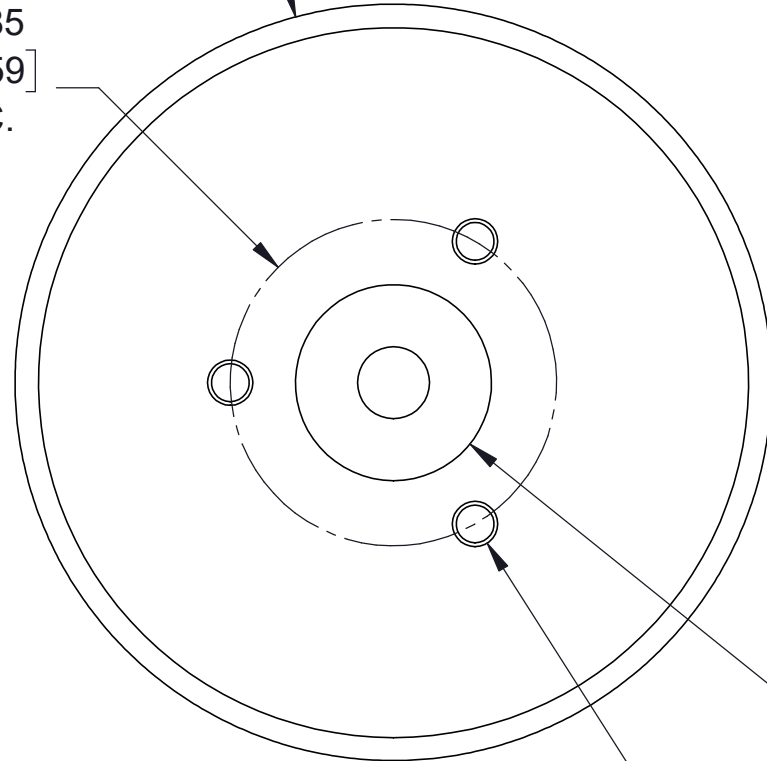

R.26  
[6.48]

∅ .31 [8]  
∅ .165 [4.20] ∇ .685 [17.40]  
M5X0.8 - 6H ∇ .300 [7.62]  
PRESSURE PORT

1.52 X 45°

3X ∅ .098 [2.50] ∇ .189 MAX [4.80 MAX]  
M3 - 6H ∇ .130 MIN [3.30 MIN]  
EQ. SP.

.276<sup>+.000</sup><sub>-.005</sub>  
[7.01<sup>.00</sup><sub>-.12</sub>]

NOTES:

- ALL DIMENSIONS ARE REFERENCE UNLESS OTHERWISE SPECIFIED.

PROPRIETARY ITEM:  
THIS DRAWING CONTAINS  
INFORMATION PROPRIETARY TO NEW  
WAY MACHINE COMPONENTS, INC. ANY  
REPRODUCTION, DISCLOSURE, OR USE  
OF THIS DRAWING OR THE  
INFORMATION CONTAINED HEREIN  
IS EXPRESSLY PROHIBITED EXCEPT AS  
NEW WAY MAY OTHERWISE AGREE TO  
IN WRITING. ALL RIGHTS RESERVED BY  
NEW WAY MACHINE COMPONENTS, INC.

<small>TOLERANCES UNLESS OTHERWISE SPECIFIED</small> <small>ANGLES: ± 1/2°</small> <small>DECIMALS: XX ± .01</small> <small>XXX ± .005</small> <small>FRACTIONS: ± 1/64</small> <small>SURFACE ROUGHNESS:  RMS MAX</small> <small>BREAK ALL SHARP EDGES: .005-.020</small>	TITLE: 50mm FLAT ROUND AIR BEARING		 air bearings	
	DRAWN: BM	DATE: 7/2/2019		
	CHECKED:	DATE:	HEAT TREAT: N/A	
	SCALE: 2:1	SHT. 1 OF 1	FINISH: N/A	
	USED ON (NW #):	N/A		DWG. #:
			DWG. #:	S105001
			REV.:	E

4

3

2

1